

NIST H-44 REQUIRES THAT ON THE APPROACH ENDS OF THIS VEHICLE SCALE, THERE SHALL BE A STRAIGHT APPROACH AT LEAST 30 FEET LONG. NOT LESS THAN 10 FEET OF ANY APPROACH ADJACENT TO THE PLATFORM SHALL BE LEVEL AND CONSTRUCTED OF CONCRETE OR SIMILAR DURABLE MATERIAL. ANY SLOPE IN THE REMAINING PORTION OF THE APPROACH SHALL INSURE EASE OF VEHICLE ACCESS, EASE FOR TESTING PURPOSES, AND DRAINAGE AWAY FROM THE SCALE.

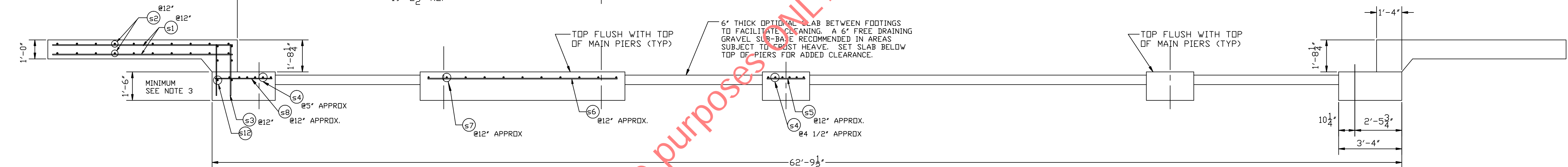

ELEVATION SECTION

APPROX. EXCAVATION W/O OPTIONS	73 CU. YDS.
CONCRETE	
PIERS (*)	9 1/2 CU. YDS.
APPROACHES/WALLS	12 CU. YDS.
6" OPTIONAL SLAB	15 CU. YDS.

(\*) PIERS CONCRETE QUANTITY IS CALCULATED FOR 18 INCH FOOTER DEPTH.

NOTES:

- FOUNDATION DESIGN IS BASED ON A MINIMUM SOIL BEARING CAPACITY OF 3000 LB/SQ. FT. FOR SOIL CONDITIONS WHICH DO NOT MEET THIS SPECIFICATION, CONSULT WITH THE THURMAN SCALE COMPANY.
- THE FOUNDATION SHALL BE INSTALLED AT AN ELEVATION AND LOCATION TO INSURE ADEQUATE DRAINAGE AWAY FROM SCALE. A PERIMETER TRENCH AND AGGREGATE BASE MAY BE ADDED IF DRAINAGE WILL NOT BE SUFFICIENT TO MAINTAIN 3000 LB/SQ. FT. BEARING CAPACITY.
- BOTTOM OF FOOTERS SHOULD EXTEND BELOW THE FROST LINE AND BE POURED MONOLITHICALLY WITH THE 10 FT. APPROACHES AND OPTIONAL SLABS OR FROST BARRIERS. AN 18 INCH FOOTER DEPTH IS MINIMUM.
- REINFORCING STEEL IS TO CONFORM TO ASTM A615 GRADE 60 SPECIFICATIONS.
- CONCRETE OF 4000 PSI MINIMUM COMPRESSIVE STRENGTH IS REQUIRED. CONSOLIDATE CONCRETE INTO POSITION BY VIBRATING.
- PIERS MUST BE LEVEL AND IN THE SAME PLANE WITHIN ±1/8 INCH.
- EXCAVATION, FORMS, REINFORCING STEEL AND CONCRETE FURNISHED BY OTHERS.
- ANCHOR BOLTS MAY EITHER BE POURED IN PLACE, OR DRILLED. SEE SECTION D-D.
- FOUNDATION REQUIREMENTS VARY FROM STATE TO STATE. CHECK WITH LOCAL WEIGHTS AND MEASURES DIVISION BEFORE CONSTRUCTION.
- WEIGHBRIDGE DECK IS FACTORY WELDED, READY TO USE. REFER TO SCALE INSTALLATION MANUAL PRIOR TO SETTING SCALE MODULES.

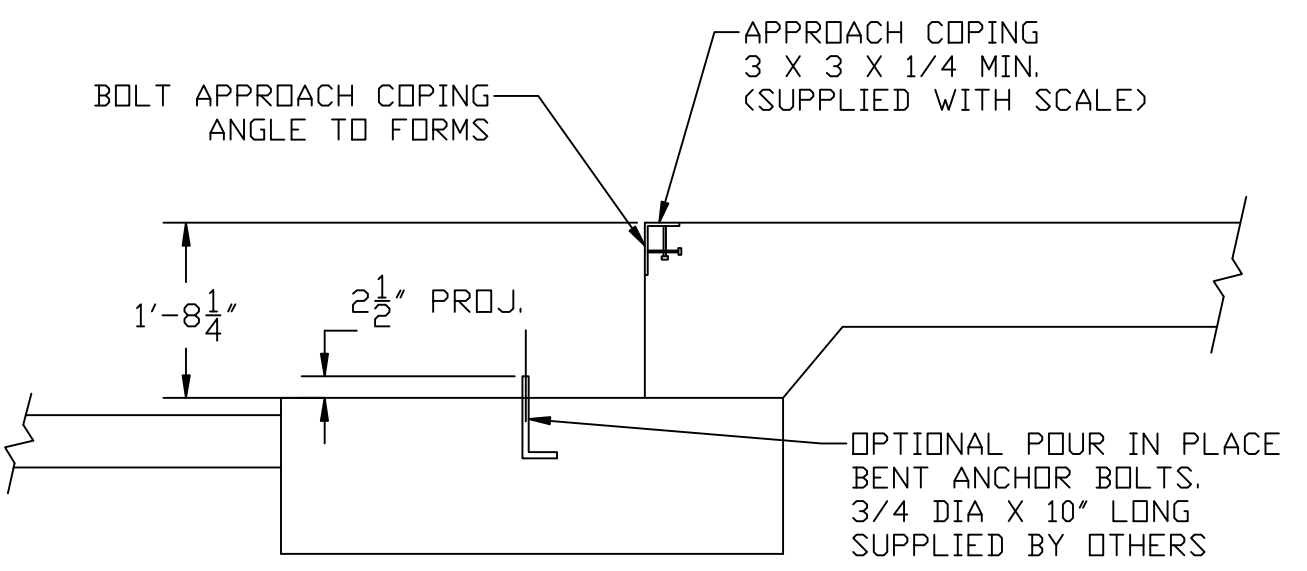

SECTION D-D

DRILL TYPE ANCHOR INFORMATION  
(DRILL TYPE ANCHORS PROVIDED WITH THE SCALE)  
5/8" DIA X 6" STUD TYPE ANCHORS  
DRILL DIA 5/8", DRILL DEPTH 3 1/2"

SYM.	QTY.	SIZE	LENGTH	TOTAL WT.	REMARKS
S1	60	#4	9'-6"	381 LBS.	(30) EACH APPROACH TOP & BTM
S2	40	#4	14'-9"	394 LBS.	(20) EACH APPROACH TOP & BTM
S3	60	#4	2'-6"	100 LBS.	(30) EACH END WALL VERT
S4	18	#6	14'-9"	399 LBS.	(6) EACH MAIN PIER
S5	15	#4	2'-0"	20 LBS.	(15) IN CENTER PIER
S6	2	#4	10'-0"	15 LBS.	LONG FULCRUM PIER
S7	15	#4	2'-0"	20 LBS.	FULCRUM PIERS
S8	30	#4	2'-9"	55 LBS.	(15) EACH END PIER
S9	2	#4	2'-0"	3 LBS.	FULCRUM PIER
S10	2	#4	2'-0"	3 LBS.	LC PIER
S11	3	#4	1'-0"	2 LBS.	LC PIER
S12	12	#4	14'-9"	118 LBS.	(6) EACH END WALL/PIER/APPR.
TOTAL REBAR WEIGHT				1,510 LBS.	

THIS DRAWING IS SUPPLIED AS CHECKED BELOW:

REFERENCE (ESTIMATES ONLY, NOT FOR CONSTRUCTION)

CERTIFIED FOR CONSTRUCTION, THURMAN#

CUSTOMER: \_\_\_\_\_ DATE: \_\_\_\_\_

CUSTOMER APPROVAL, RETURN ONE COPY.

(ORDER ON HOLD UNTIL SIGNED COPY IS RETURNED)

APPROVED AS DRAWN, APPROVED BY: \_\_\_\_\_ DATE: \_\_\_\_\_

APPROVED AS NOTED, APPROVED BY: \_\_\_\_\_ DATE: \_\_\_\_\_

TOLERANCES (UNLESS OTHERWISE SPECIFIED) ± 1/8"

DIMENSIONS ARE IN INCHES (UNLESS OTHERWISE SPECIFIED)

THURMAN SCALE COMPANY  
255 E. LIVINGSTON AVE.  
COLUMBUS, OHIO 43215  
PH (614) 221-9077  
FAX (614) 221-8879

This drawing is the property of Thurman Scale Company and is loaned to the recipient for his/her confidential use only. In consideration of the loan of this drawing, the recipient promises and agrees that it shall not be used in any way detrimental to the interest of Thurman Scale Company, that it shall be returned upon request, and that it shall not be reproduced, copied, loaned or otherwise disposed of, directly or indirectly without the express written consent of Thurman Scale Company.

TITLE: 8130 55K 60' X 10' READY-TO-POUR FOUNDATION (3S, 6" PIPE, M=213.75)

DATE: 04-26-06  
DRAWN BY: HAWKINS  
DRAWING NUMBER: 92024-FT  
REV: 0